

Koroseal Wall Protection Systems

Stainless Steel Recessed Corner Guard

Installation Instructions

Important: **KOROGARD**® Stainless Steel Recessed Corner Guard must be installed prior to gypsum wall board installation. If more than one layer of gypsum wall board is to be installed (fire-rated) on wall surface, install **KOROGARD** Stainless Steel Recessed Corner Guard with last layer of gypsum wall board.

Recommended Installation Equipment: Drill/Screw Gun and Screw Bit

Pre-Installation:

1. **KOROGARD** Stainless Steel Recessed Corner Guard is supplied in specified lengths and includes attachment holes. A peel-off plastic coating protects the finished face of the **KOROGARD** Stainless Steel Recessed Corner Guard.
2. Check material compliance with Project Specifications and for any damage that may have occurred during shipment and/or handling of the material. Material must be stored, installed, and used in a controlled environment.
3. Locate and install **KOROGARD** Stainless Steel Recessed Corner Guard in accordance with architectural drawings and specifications. When required, **KOROGARD** shop/location drawing(s) should be used in conjunction with these documents.

Installation:

1. Partially remove protective coating from screw flange.
2. Fasten **KOROGARD** Stainless Steel Recessed Corner Guard to corner studs with 3/4" (12.7mm) Flat-Head Screws utilizing provided screw holes. Screws not included.
3. Install Gypsum Wall Board over **KOROGARD** Stainless Steel Recessed Corner Guard mounting flange. Use drywall j-trim to finish edge of drywall. See Detail.
4. Remove remaining protective coating. Clean with dry or slightly damp cloth as necessary.

If you have any questions during installation, please contact your local **KOROGARD** representative.

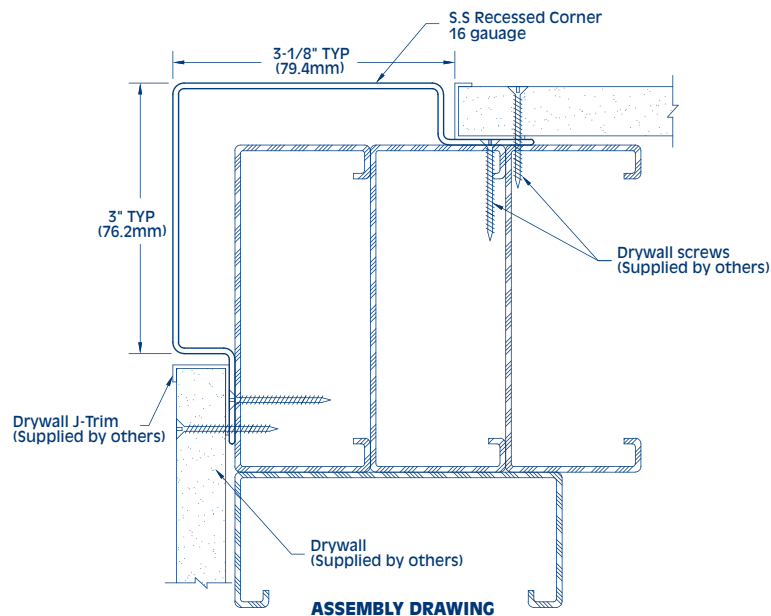

KOROGARD®
WALL PROTECTION SYSTEMS

800-628-0449 • www.korogard.com • Division 10 26 00